



Within Our Reach



Growing the Movement for a
Healthier Willamette

December 13-14, 2018

Salem Convention Center



WILLAMETTE RIVER
INITIATIVE

Welcome

Welcome to Within Our Reach 2018:
Growing the Movement for a Healthier Willamette.

This year's conference marks a decade of collaboration to care for the Willamette Basin's waterways and a transformative moment as the Willamette River Initiative prepares to become a community-led network. Together, we've changed the way our river system is being restored, and how we think about communities and rivers thriving together. We are grateful to many for the successes of the past 10 years: Conservation practitioners, scientists, advocates and community members working to elevate river health, our funding partners Oregon Watershed Enhancement Board and Bonneville Power Administration, and our program partners at the Bonneville Environmental Foundation.

We are committed to the work of sustaining and growing this river community in the future, with an increasing focus on equity and human health. Our conference reflects that vision.

Thank you for coming. We're excited to see what we can accomplish together in the future.

Sincerely,
Allison Hensey
Willamette River Initiative Director
Meyer Memorial Trust

Table of Contents

| | |
|-----------------------------|-----------|
| Schedule At-A-Glance | pg. 4-5 |
| Venue Map | pg. 6-7 |
| Mainstage Presenters | pg. 8-12 |
| Thursday Agenda | pg. 13-18 |
| Friday Agenda | pg. 19-22 |
| Posters | pg. 23-25 |
| About | Back page |

We will document the event with photography and video. Please visit the registration table if you would like to opt out.



At-A-Glance | December 13

| | |
|---|--|
| 7:30am <i>Willamette Ballroom</i> | Registration & Breakfast |
| 8:30am <i>Willamette Ballroom</i> | Welcome & Introductory Remarks |
| 8:40am <i>Willamette Ballroom</i> | Opening Invocation & Performance |
| 9:10am <i>Willamette Ballroom</i> | Opening Keynote Growing the Movement for a Healthier Willamette |
| 9:40am <i>Willamette Ballroom</i> | Sharing a Vision for a Willamette River Network |
| 10:15am | Break |
| 10:30am | CONCURRENT BREAKOUT SESSIONS |
| <i>Croisan Creek A&B</i> | Toward a Holistic Vision for Salmon and Steelhead Restoration |
| <i>Croisan Creek C</i> | Returning Traditional Ecological Knowledge to the Landscape |
| <i>Santiam 4</i> | Conservation and Health Partnerships |
| <i>Santiam 5</i> | Lessons in Regional Collaboration |
| 12:00pm <i>Willamette Ballroom</i> | Lunch |
| 1:00pm <i>Willamette Ballroom</i> | Moving from “Why” to “How”: Equity and Inclusion in the Practice of Conservation |
| 2:15pm <i>Willamette Ballroom</i> | Equity Flash Talk |
| 2:30pm <i>Willamette Foyer</i> | Poster Session |
| 3:30pm | Break |
| 3:45pm | CONCURRENT BREAKOUT SESSIONS |
| <i>Croisan Creek A&B</i> | Brewing a Watershed Revolution |
| <i>Croisan Creek C</i> | Culturally-Relevant Watershed Education in the Willamette |
| <i>Santiam 4</i> | Restoring an Urban River |
| <i>Santiam 5</i> | A Strategic Approach to Supporting Healthy Willamette River Side Channels |
| 5:15-6:45pm <i>Willamette Ballroom</i> | Evening Reception |

At-A-Glance | December 14

| | |
|---------------------------------------|---|
| 7:30am <i>Willamette Ballroom</i> | Registration & Breakfast |
| 9:00am <i>Willamette Ballroom</i> | Welcome & Introductory Remarks |
| 9:10am <i>Willamette Ballroom</i> | Opening Address from Oregon Watershed Enhancement Board |
| 9:30am <i>Willamette Ballroom</i> | Science Plenary Ode to the Willamette |
| 10:15am <i>Willamette Ballroom</i> | Science Flash Talk |
| 10:30am | Break |
| 11:00am <i>Willamette Ballroom</i> | Pathways to Funding Watershed Conservation: It's Not Always a Straight Line |
| 12:00pm <i>Willamette Ballroom</i> | Lunch & Recognizing River Heroes |
| 1:00pm | CONCURRENT BREAKOUT SESSIONS |
| <i>Croisan Creek A</i> | Developing an Education Program Grounded in the Traditions of Local Tribes |
| <i>Croisan Creek B</i> | Making the Case for Supporting Watershed Resiliency |
| <i>Croisan Creek C</i> | Understanding the Willamette's Coldwater Refuges |
| 2:30pm | Break |
| 2:40pm <i>Willamette Ballroom</i> | Closing Keynote Re-envisioning a River Neighborhood in Portland's Albina District |
| 3:15pm | Closing Remarks |

Thank You to Our Conference Partner



Venue Map | First Floor

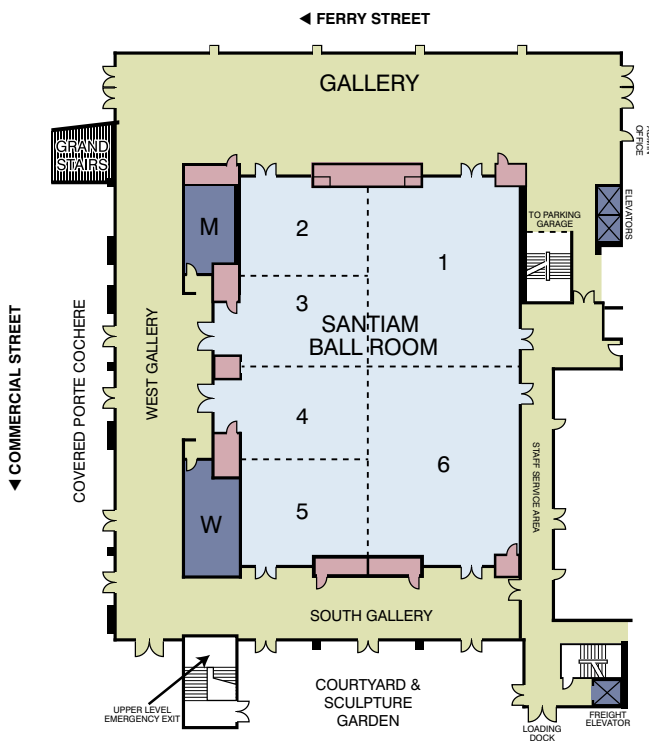

Santiam 4

- Thursday Breakout Sessions

Santiam 5

- Thursday Breakout Sessions

Venue Map | Second Floor

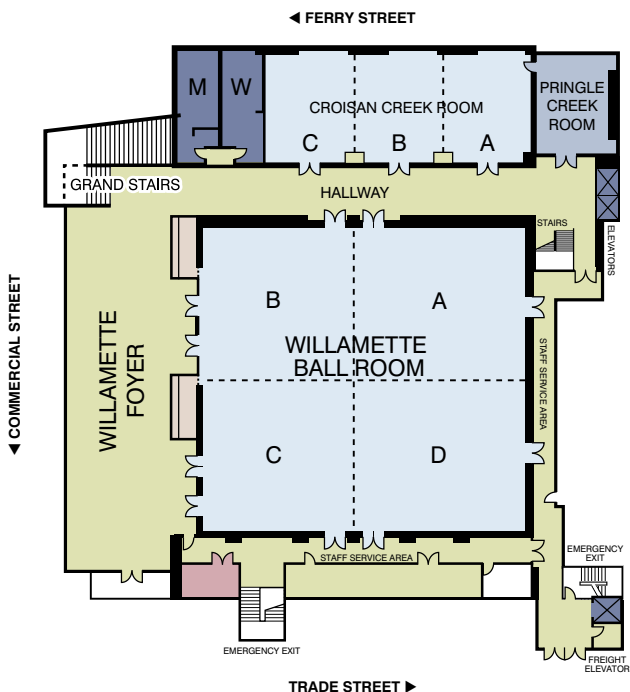

Willamette Foyer

- Registration
- Poster Session

Willamette Ballroom

- Plenary Presentations
- Breakfast, Lunch & Thursday Evening Reception

Croisan Creek A&B Combined

- Thursday Breakout Sessions

Croisan Creek A

- Friday Breakout Sessions

Croisan Creek B

- Friday Breakout Sessions

Croisan Creek C

- Thursday & Friday Breakout Sessions

Pringle Creek

- Resting/Mother's Room

Mainstage Presenters



Rukaiyah Adams

Rukaiyah Adams is Chief Investment Officer of the Meyer Memorial Trust and Board Chair of the Alb!na Vision Trust, a Portland nonprofit working to reinvigorate a historically black riverfront neighborhood. She is a member of the board of directors of Oregon Public Broadcasting and chair of the Oregon Investment Council. Before joining Meyer, Rukaiyah was director of investment management at The Standard. She started her career as a mergers and acquisitions lawyer at Skadden, Arps, Slate, Meagher & Flom in San Francisco and her pro bono work includes negotiating on behalf of the Lawyer's Committee for Civil Rights, the Homeless Prenatal Project and the National Children's Defense Fund.



Jonathan Blasher

Jonathan Blasher is Parks and Nature Director for Metro, a regional government in Portland that manages growth, infrastructure and development issues across jurisdictional boundaries. Metro Parks and Nature protects water quality, fish and wildlife habitat, and creates opportunities to enjoy nature through a system of parks, trails and natural areas. Born and raised in Eugene, Jonathan has devoted his life to serving communities. He earned a BA from UC Santa Cruz and Executive MBA from the University of Oregon. Jonathan is a Senior Fellow of the American Leadership Forum of Oregon, Oregon State Parks and Recreation Commissioner, Harper's Playground advisory council member, All Hands Raised board member and AmeriCorps alumni.



Marcelo Bonta

A thought leader in the environmental movement, Marcelo Bonta brings almost two decades of experience facilitating individual, organizational, and systemic J.E.D.I. (justice, equity, diversity, and inclusion) change processes. Originally trained as a conservation biologist, Marcelo dedicated his career to J.E.D.I. after his experience working as the sole programmatic person of color at a national conservation organization. He has worked for The Raben Group and Meyer Memorial Trust, and founded the Center for Diversity & the Environment and Environmental Professionals of Color. Look for his latest project, a blogsite called JEDIHeart.com, in the new year.



Belinda Brown

Belinda Brown is an ecocultural restoration practitioner with expertise in Traditional Ecological Knowledge who has served Indian Country for 20 years in intergovernmental affairs coordination, strategic planning and community development.

As Lomakatsi Restoration Project's Tribal Partnership Manager, Belinda works closely with Lomakatsi's executive director and staff leadership to serve tribal communities in their efforts to restore forests and watersheds on tribal trust and ancestral lands. Belinda is an enrolled member of the Kosealekte Band of the Ajumawi-Atsuge Nation, (Pit River Tribe), and has served as an elected official on the Pit River Tribal Council, as an appointed delegate at local, state and national levels.



Chanté Coleman

Chanté Coleman is Director of the National Wildlife Federation's Choose Clean Water Coalition, where she leads the Coalition's work to protect the Chesapeake Bay by bringing together more than 230 organizations in the watershed. She works on federal and state policies to increase funding for

clean water projects in the region, promotes grassroots/grasstops outreach, fosters collaboration among Coalition members, and advances diversity, equity, inclusion and justice in the watershed. Chanté also co-leads the National Wildlife Federation's Diversity, Equity, Inclusion, and Justice Steering Committee. As a firm believer in self-care, she practices yoga and meditates.



Debbie Craig

Debbie Craig is driven by a passion for public education and the outdoors. Oregonian roots provided Debbie with an excellent public education and access to amazing outdoor experiences, inspiring her future work as an advocate for education and land conservation. A family law

attorney, Debbie has served as chair or on the boards of Friends of the Columbia Gorge, Education Foundation, Stand for Children, Columbia Land Trust and National Advisory Council of the Land Trust Alliance. She has also successfully led many education bond measures. She was recognized as Lake Oswego's Citizen of the Year in 2013. Debbie joined Meyer Memorial Trust's Board of Trustees in 1995.

Mainstage Presenters



Michelle J. DePass

Michelle J. DePass is President and CEO of Meyer Memorial Trust and a national leader at the intersection of social, economic and environmental justice. Her rich interdisciplinary background includes grassroots community organizing, philanthropy, government and academia. She is known for bringing people together and prioritizing justice for people of color, women, immigrants, indigenous peoples and low-income communities. As assistant administrator of the Environmental Protection Agency during the Obama administration, Michelle participated in international environmental treaty negotiations and created the Office of International and Tribal Affairs, elevating for the first time the agency's recognition of the sovereign rights of indigenous peoples in the United States.



Stan Gregory

Stan Gregory has spent a career studying the Willamette and other Pacific Northwest streams, rivers and lakes. He received his B.S. at the University of Tennessee in 1971 and his M.S. and Ph.D. from Oregon State University in 1974 and 1980. After starting his career with the U.S. Fish & Wildlife Service in the Pacific Northwest, Stan joined the Oregon State University Department of Fisheries & Wildlife faculty, where he has served for more than 35 years. His fields of expertise include stream ecosystems, influence of human activities on ecosystem structure and function, and development of restoration perspectives and practices that are consistent with natural stream processes.



Kathleen Guillozet

Kathleen (Kas) Guillozet manages the Bonneville Environmental Foundation Willamette Model Watersheds Program and leads other basin-wide monitoring, peer to peer learning and knowledge sharing efforts. Kathleen has worked as a consultant on collaborative planning and habitat enhancement projects and is an adjunct faculty at Marylhurst University. She has conducted scientific research into environmental topics, managed habitat enhancement projects and worked as a science educator, researcher and writer. She is interested in social and ecological dimensions of resource management, ecosystem services, working lands and environmental justice.



Allison Hensey

Willamette River Initiative Director Allison Hensey supports partners' collaborative work to improve the wellbeing of the Willamette Basin's people, environment and communities. Prior to joining Meyer in 2015, Allison led the Sustainable Agriculture and Watersheds Program at Oregon Environmental

Council, and before that, she served as a policy analyst with the Oregon Watershed Enhancement Board. She is a board member with the East Multnomah Soil and Water Conservation District, which helps people care for land and water.



David Lamfrom

As Director of the National Parks Conservation Association California Desert and Wildlife Programs, David Lamfrom works on policy, legislation, media, building community, and connecting desert voices to government decision makers. David has run campaigns to protect tens of thousands of acres

of sacred desert lands from inappropriate development and has worked with desert communities to designate three new national monuments totaling 1.8 million acres. David is a published author and photographer and formerly worked in wildlife biology and environmental science. He volunteers with local desert organizations, the Center for Diversity and the Environment and TREC.



Meta Loftsgaarden

Meta Loftsgaarden is Executive Director of the Oregon Watershed Enhancement Board, where she coordinates an 18-member board and directs a \$103 million biennial budget supporting programs to benefit native fish and wildlife habitat and water quality. Throughout her career, Meta has served in

leadership positions that support her passion for local economies, communities, and science-based restoration and conservation. Much of her work has focused on translating science and conservation in ways that are easily communicated to policy-makers and public audiences. She has worked closely with her staff to develop a culture of innovation and continuous improvement.



Ryan Michie

Ryan Michie is a Senior Water Quality Analyst for the State of Oregon. He works in the Watershed Management Section within the Oregon Department of Environmental Quality developing Total Maximum Daily Load plans. Ryan's recent work involves tracking progress towards establishing tree cover in the Willamette River Basin as part of Oregon DEQ's total

maximum daily load requirement for stream temperature.

Mainstage Presenters



Todd Reeve

As CEO of Bonneville Environmental Foundation, Todd Reeve pursues innovations in corporate sustainability, renewable energy and water restoration. He co-created BEF's Water Restoration Certificate® Program, the only national program enabling corporations to balance their water

footprint by restoring flows to depleted rivers, wetlands and aquifers. He developed one of the first 10-year Model Watershed restoration programs and has overseen the development and funding of more than 50 water restoration and Model Watershed projects across 12 states and Mexico. Todd is the co-creator of Change the Course and Director of Business for Water Stewardship. He has published numerous articles profiling solutions to improve flow and habitat in western waterways.

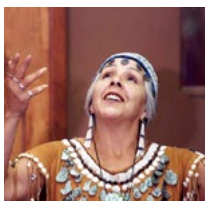

Esther Stutzman

Esther has been a traditional storyteller for over fifty years, relating stories of her ancestors, the Komemma Kalapuya and Hanis Coos. She has presented to schools, libraries and universities during this time, bringing an authentic flavor to storytelling. She was formerly a teacher, curriculum developer and historical researcher and is currently working on a

project to revive the Kalapuya language. In 2017, she was presented with the Oregon Governor's Lifetime Achievement Award for the arts.

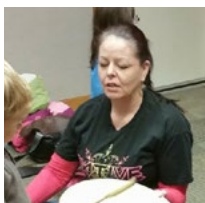

Shannin Stutzman

Shannin is Esther Stutzman's daughter who was raised in the traditions of her ancestors, the Komemma Kalapuya and Hanis Coos. She has a lifetime of experience in education and traditional youth summer camp administration. She serves as the indigenous song keeper and instructor for

the youth camp as well as presenting to many educational venues along with her mother. She is deeply involved in the Kalapuya Language project, serving as curriculum writer and researcher.

Program | Thursday, December 13

- 7:30am **Registration & Breakfast**
- 8:30am **Welcome & Introductory Remarks**
Willamette Ballroom **Emcee: Allison Hensey** | Willamette River Initiative Director, Meyer Memorial Trust
- 8:40am **Opening Invocation & Performance**
Willamette Ballroom **Esther Stutzman** | Elder, Kalapuya Tribe
Shannin Stutzman | Indigenous Song Keeper, Kalapuya Tribe
- 9:10am **Opening Keynote | Growing the Movement for a Healthier Willamette**
Willamette Ballroom **Michelle J. DePass** | President and CEO, Meyer Memorial Trust
- 9:40am **Sharing a Vision for a Willamette River Network**
Willamette Ballroom **Allison Hensey** | Willamette River Initiative Director, Meyer Memorial Trust
- 10:15am **Break**
- 10:30am **CONCURRENT BREAKOUT SESSIONS**
Croisan Creek A&B **Toward a Holistic Vision for Salmon and Steelhead Restoration**
Aquatic habitat improvements in the Willamette and its tributaries would benefit a host of river species, but ecological efforts must be considered alongside other societal needs and interests. Balancing these priorities is challenging. Yet, ample opportunity remains to better align the Willamette's flow and restoration strategies for ESA-listed fish and other species while preserving societal values. Join with stakeholders and scientists to unravel the complexities of our managed system, preview research that could inform future river management and discuss opportunities and constraints at the local, reach and basin scale.
Moderator: Liz Redon | Willamette Basin Regional Program Representative, Oregon Watershed Enhancement Board
Rose Wallick | Geomorphology Team Lead, U.S. Geological Survey
Rich Piaskowski | Fisheries Biologist, U.S. Army Corps of Engineers
Stewart Rounds | Hydrologist, U.S. Geological Survey
David Noakes | Professor & Director, Oregon Hatchery Research Center, Oregon State University
Brent Stevenson | District Manager, Santiam Water Control District

Program | Thursday, December 13

Kenneth Bierly | Former Deputy Director, Oregon Watershed Enhancement Board

Dustin Bengtson | Deputy Operations Project Manager, U.S. Army Corps of Engineers

10:30am

Croisan Creek C

Returning Traditional Ecological Knowledge to the Landscape: Native People are Native Species

Native peoples have lived in the Willamette Valley since time immemorial. Using natural methods like controlled fire, Indigenous people have encouraged the production of First Foods such as elk, deer and camas for millennia. Consequently, through coevolution within their shared ecosystems, Indigenous people and First Foods adapted over time in close relationship. Considering this deep connection, what does “vetted habitat restoration” mean? In this session, Indigenous speakers share stories of habitat restoration projects that bring traditional ecological knowledge to the center, and they offer perspective and protocols for mainstream conservation groups hoping to partner with Native communities.

Valerie Goodness, ABD PhD | Watershed Conservation & Indigenous Studies National Science Foundation Fellow, University at Buffalo, and President, TEK Initiative

Gail Woodside | TK PhD Candidate ABD, College of Agricultural Sciences, Oregon State University

10:30am

Santiam 4

Casemaking Across Sectors: Conservation and Health Partnerships

The connection between health, equity, and time in greenspace is established, but it can still be difficult to convince stakeholders to engage in this cross-sector space. In this session, dive into the science behind the health-nature connection and explore strategies to make the case for equity-focused collaboration with health sector partners to your board and staff, policymakers, funders, communities, and potential new partners. Speakers will highlight some success stories and share practical casemaking tools and strategies.

Moderator: Emily Henke, MPH | Co-Leader, Oregon Health & Outdoors Initiative, Oregon Public Health Institute

Moderator: Barton Robison, MPA | Co-Leader, Oregon Health & Outdoors Initiative, Willamette Partnership

Chad Brown | Founder & President, Soul River Inc.
Bobby Cochran, PhD | Senior Fellow, National Policy Consensus Center
Tatiana Dierwechter, MSW | Health Policy and Prevention Manager, Healthy Communities Program, Benton County Health Department
Zeenia Junkeer, ND | Director, Oregon Health Equity Alliance (OHEA)

10:30am
Santiam 5

Lessons in Regional Collaboration: The Upper Willamette Stewardship Network

Nonprofit conservation leaders are familiar with the struggle: Your organization's mission is connected to ecosystem-scale challenges, but limited resources and geographic reach make it difficult to match efforts to the scale of the need. In this session, learn how six conversation groups in the Upper Willamette created a network to boost their impact on their shared geography. Members of the Upper Willamette Stewardship Network will share how and why they formed the network, why they chose to collaborate on diversity, equity and inclusion and other efforts, and the transferable lessons they've learned in the early stages of this partnership.

Sarah Dyrdaahl | Executive Director, Middle Fork Willamette Watershed Council
Amanda Gilbert | Executive Director, Coast Fork Willamette Watershed Council
Clinton Begley | Executive Director, Long Tom Watershed Council
Jared Weybright | Executive Director, McKenzie Watershed Council

12:00pm

Lunch

1:00pm
Willamette Ballroom

Moving from "Why" to "How": Equity and Inclusion in the Practice of Conservation

Many mainstream conservation leaders have begun to view the pursuit of diversity, equity and inclusion as a moral imperative within their work. But the question of "how" can pose a challenge. What does it look like to work effectively toward a more diverse, just environmental movement, and how can we measure progress? During this moderated discussion, conservation leaders will share insights from their experience translating equity values into practice. They'll offer tangible examples of how to work with diverse communities to achieve conservation goals, present case studies of watershed

Program | Thursday, December 13

restoration conducted with an equity lens, and lay out a roadmap for how practitioners can replicate these examples to better serve the Willamette community.

Moderator: Marcelo Bonta | Principal, The Raben Group and President, Marcelo Bonta Consulting LLC
David Lamfrom | Director, California Desert and National Wildlife programs, National Parks Conservation Association

Chanté Coleman | Director, Choose Clean Water Initiative, National Wildlife Federation

Belinda Brown | Tribal Partnerships Manager, Lomakatsi Restoration Project

2:15PM
Willamette
Ballroom

Equity Flash Talk | Creating an Equitable Parks and Nature System

This year, the Parks and Nature Department of Metro developed a Racial Equity, Diversity and Inclusion Action Plan designed to make Metro's parks and natural areas more safe and welcoming for diverse communities. The plan identifies dozens of actions the department can take over the next 5 years to achieve this goal, from working with communities of color to design more welcoming parks and collaborating with the Native American community to increase access to cultural resources in Metro parks, to diversifying the department's workforce. Learn about the process and vision behind the new action plan.

Jon Blasher | Director of Parks and Nature, Metro

2:30pm
Willamette
Foyer

Poster Session

Learn about exciting restoration, science and community engagement projects happening in the Willamette and discuss the projects with poster presenters. (*Posters listed on p. 23*)

3:30pm

Break

3:45pm

CONCURRENT BREAKOUT SESSIONS

Croisan Creek
A&B

Brewing a Watershed Revolution: How Local Farmers and Craft Brewers are Transforming Willamette Valley Hop Farming

As major Willamette Valley land managers and water users, farmers play a critical role in water quality and habitat protection. This is certainly true of hop growers, whose product caters to a beer making industry that needs clean, abundant water to operate. Learn how the Valley's hop farmers and brewers are teaming up with Salmon-Safe, a nonprofit watershed protection organization, in a market-based

partnership to reduce agricultural runoff, restore habitat and adopt other watershed-friendly practices. Farmers and beer makers will share how they've transitioned to Salmon-Safe certification, the challenges they've encountered, and how market-based conservation incentives can apply to other agricultural sectors.

Moderator: Dan Kent | Executive Director, Salmon-Safe, Portland

Gayle Goschie | Hops & Wine Grapes, Goschie Farms, Silverton

John Coleman | Perennial Crops Manager, Coleman Agriculture, Gervais

Christian Ettinger | Founder & Brewer, Hopworks Urban Brewing, Portland

Julia Person | Sustainability Manager, Widmer Brothers, Portland

3:45pm

Croisan Creek C

Culturally-Relevant Watershed Education in the Willamette: Current Status, Implications and Opportunities

As Oregon's population grows more diverse, understanding how different communities interact with the Willamette River system is crucial to developing successful watershed restoration efforts. Gladys Ruiz, a culturally-relevant environmental education and youth workforce development consultant, recently completed an assessment of the needs and gaps around culturally-relevant education connected to the Willamette. Ruiz found a gap in baseline understanding of what is needed to provide culturally-relevant education between Community Based Organizations working primarily with communities of color and historically white-led environmental organizations. Ruiz will share findings and strategies that have emerged from her analysis, including a new project to build relationships between Community Based Organizations and historically white-led environmental organizations.

Gladys Ruiz | Culturally Relevant Education Consultant, Gladys Ruiz Consulting

3:45pm

Santiam 4

Restoring an Urban River: Oaks Bottom a New Vision for the Lower Willamette Floodplain

The Lower Willamette River is more than just a corridor for salmonids to move through on their way to upstream spawning grounds or out to the Pacific Ocean. A new project to restore habitat connectivity in Oaks Bottom, the Lower Willamette's largest undeveloped floodplain, challenges the notion that

habitat restoration isn't possible in an urban river. Learn about the Oaks Bottom project and other existing and proposed projects in the Lower Willamette. Then, take part in an interactive visioning session to imagine future strategies to improve habitat in the Lower Willamette with climate change in mind.

Kaitlin Lovell | Science Integration Division Manager, City of Portland Bureau of Environmental Services

Paul Ketcham | Sr. Environmental Manager, City of Portland Bureau of Environmental Services

Sean Bistoff | Capital Project Manager, City of Portland Bureau of Environmental Services

Jeff Caudill | Environmental Planner, City of Portland Bureau of Planning and Sustainability

3:45pm
Santiam 5

A Strategic Approach to Supporting Healthy Willamette River Side Channels

The Willamette River's alcoves, sloughs and backwaters are critical for supporting native plants and animals, including endangered fish. Their calm waters also invite invasive aquatic plants that can degrade habitats, outcompete native species and impair water quality. Landowners and conservation groups are working together to combat aquatic invasives, particularly water primrose (*Ludwigia* spp.) and yellow floating heart (*Nymphoides peltata*). Learn about the distribution and impacts of aquatic invasive plants along the Willamette River and hear how practitioners are coming together to create a regional action plan for addressing this problem.

Moderator: Brian Bangs | Native Fish Investigations, Oregon Department of Fish and Wildlife

Laura Brown | River Restoration and Invasive Species Program Coordinator, Benton Soil & Water Conservation District

Rich Miller | Research Assistant, Portland State University's Center for Lakes and Reservoirs

Kurt Carpenter | Hydrologist/Aquatic Ecologist, U.S. Geological Survey

Marci Krass | Restoration Program Manager, Willamette Riverkeeper

Andrea Berkley | Natural Resources Specialist, Valleys Region, Oregon Parks and Recreation Dept.

5:15–6:45pm **Evening Reception**
*Willamette
Ballroom*

Program | Friday, December 14

- 7:30am **Registration & Breakfast**
- 9:00am **Welcome & Introductory Remarks**
Willamette Ballroom **Debbie Craig** | Trustee Board Member, Meyer Memorial Trust
- 9:10am **Opening Address from OWEB**
Willamette Ballroom **Meta Loftsgaarden** | Executive Director, Oregon Watershed Enhancement Board
- 9:30am **Science Plenary | Ode to the Willamette**
Willamette Ballroom The last 10 years have been quite a ride. Together, we've set the stage for unprecedented restoration gains and a deeper understanding of the river system that sustains us. And yet, a reflection on the past decade of Willamette Basin restoration isn't complete without considering the long and complex path that got us here. Professor Stan Gregory, who has spent his career working for a healthier Willamette, will use science and storytelling to reflect on this history and honor the Willamette as an ecologically special system worth striving for. Through these stories, Gregory will lead us in a celebration of our river, lend perspective to how far we've come, and offer keen advice on how to shepherd and build upon these learnings in the next era of Willamette River restoration.
Stan Gregory | Distinguished Professor of Fisheries-Emeritus, Oregon State University
- 10:15am **Science Flash Talk | Tracking Streamside Vegetation To Measure Progress Toward Healthier Water Temperatures**
Willamette Ballroom Due to heat pollution, many Willamette Basin water bodies do not meet Clean Water Act standards for stream temperature. Overheated streams are a barrier to recovering native coldwater fish populations, and they also can contribute to toxic algal blooms like the one that forced a weeks-long drinking water advisory in the Salem area last summer. Learn about how the Oregon Department of Environmental Quality sets Clean Water Act targets for streamside vegetation - and current progress toward achieving targets in the Willamette.
Ryan Michie | Senior Water Quality Analyst, Oregon Department of Environmental Quality
- 10:30am **Break**

Program | Friday, December 14

11:00am
Willamette
Ballroom

Pathways to Funding Watershed Conservation: It's Not Always a Straight Line

Funding has long been a critical driver in scaling up restoration in the Willamette Basin. Despite being Oregon's most populous and economically valuable watershed, the Willamette has suffered from a dearth of reliable funding sources committed to its long-term health. As the Willamette River Initiative prepares to transition outside of Meyer Memorial Trust in 2019, there is a need for resilient new funding streams. Guillozet and Reeve will showcase examples of successful alternative funding approaches in the Willamette and other areas of the U.S., digging into the key characteristics these approaches share. Using these examples, they'll calibrate expectations around new and different funding sources that could help sustain restoration progress in the Willamette.

Todd Reeve | Chief Executive Officer, Bonneville Environmental Foundation

Kathleen Guillozet | Willamette Model Watershed Director, Bonneville Environmental Foundation

12:00pm

Lunch & Recognizing River Heroes

1:00pm

CONCURRENT BREAKOUT SESSIONS

Croisan Creek A

Cultural Ecology: Developing an Education Program Grounded in the Traditions of Local Tribes

In Portland, a new Indigenous-focused Cultural Ecology program from Friends of Tryon Creek demonstrates how environmental educators can collaborate with culturally-specific organizations to increase their programs' cultural relevancy and cultivate diverse youth leadership in the conservation field. This program uses immersive experiences in Portland's Tryon Creek State Natural Area to strengthen Indigenous students' cultural connection, which encompasses an ethic of land stewardship and leadership. In this session, presenters will share lessons learned from a 2017 pilot run and detail plans to expand and improve the program.

Gabe Sheoships | Education Director, Friends of Tryon Creek

Gerardo Rodriguez | Board Member, Friends of Tryon Creek

1:00pm

Croisan Creek B

Making the Case for Supporting Watershed Resiliency: Cities and Utilities as Key Stakeholders

Drinking water providers, wastewater managers, cities and other municipalities have a vested interest and, often, legal responsibility for maintaining clean, abundant water in the Willamette and its tributaries. How can restoration groups partner with these entities to the benefit of all? Three case studies will explore the role cities and utilities can play in watershed restoration - including, potentially, as funders - and offer perspectives on how efforts like these can be scaled up or replicated elsewhere in the Willamette. Learn about the opportunities and challenges these partnerships present and hear directly from stakeholders who will be in the audience to share their reflections.

Moderator: John Audley | Rural Economic Development Consultant, John Audley Consulting
Rebecca McCoun | Council Coordinator, North Santiam Watershed Council

Karl Morgenstern | Water Quality & Source Protection Supervisor, Eugene Water & Electric Board
Susie Smith | Executive Director, Oregon Association of Clean Water Agencies

1:00pm

Croisan Creek C

Understanding the Willamette's Coldwater Refuges: Learnings and Implications for Future Restoration

When summertime temperatures in the Willamette River become perilously warm for salmon, steelhead and other native fish, naturally-occurring pockets of cooler water offer a safe haven. As climate change warms our rivers and streams, how can we protect and enhance these cold water refuges to help native fish survive? A host of agencies have come together to discuss the Willamette's coldwater refuges, including how they're formed, how river geomorphology, flow and other factors influence them and what humans can do to protect them. In this session, presenters will share how their findings could inform a restoration strategy designed to preserve and enhance these vital habitats.

Moderator: Stewart Rounds | Hydrologist, U.S. Geological Survey

Krista Jones | Hydrologist, U.S. Geological Survey
Stan Gregory | Distinguished Professor of

Program | Friday, December 14

Fisheries-Emeritus , Oregon State University
Luke Whitman | Assistant Project Leader, Oregon
Department of Fish & Wildlife Corvallis Research Lab
Rose Wallick | Geomorphology Team Lead, U.S.
Geological Survey

2:30pm

Break

2:40pm
*Willamette
Ballroom*

Closing Keynote | Re-envisioning a River Neighborhood in Portland's Albina District

Rukaiyah Adams is from river people. She grew up in Albina, an African-American community in Portland that is deeply connected – through flood events, world history and social justice – to the Willamette River. Her family fished the river. She played in the river. To this day, she runs along the river for comfort. Rukaiyah will share some of her Oregon story and images from her work on the *Alb!na Vision*, an effort to rebuild lower Albina, particularly sections along the east bank of the Willamette River in Portland's central city. Through the *Alb!na Vision*, she has learned that people come to the work of river stewardship, conservation and protection from different experiences and values. Rukaiyah will challenge and inspire us to expand our thinking about environmental stewardship.

Rukaiyah Adams | Chair, Alb!na Vision Trust, and
Chief Investment Officer, Meyer Memorial Trust

3:15pm
*Willamette
Ballroom*

Closing Remarks

Posters



Stage 0 Alluvial Valley Restoration in the McKenzie River Sub-basin

Kate Meyer | Fisheries Biologist, U.S. Fish and Wildlife Service, Willamette National Forest, McKenzie River Ranger District



Increasing the Pace and Scale: A Glimpse of the Next 10 Years of OPRD's Willamette Basin Program

Andrea Berkley | Natural Resource Specialist, Oregon Parks and Recreation Department



Building Trust through Community Engagement: How Early Efforts Create Long-Term Gains

Gale Orcutt Darling | Community Engagement Coordinator, Middle Fork Willamette Watershed Council



Water is the Connection

Sharon Selvaggio | Program Director, Healthy Wildlife and Water, Northwest Center for Alternatives to Pesticides



Metro

Willamette Falls Riverwalk: Restoring Habitat and Public Access Lost to Generations of Industrialization at Willamette Falls in Oregon City

Brian Moore | Project Manager, Willamette Falls Legacy Project, Metro

Brian Vaughn | Senior Natural Resources Scientist, Metro



Freshwater Mussel Research and Conservation in the Willamette and Beyond

Emilie Blevins | Conservation Biologist, Endangered Species Program, Xerces Society for Invertebrate Conservation



Assessing Benefits from Willamette Valley Wetlands and Streams

Jimmy Kagan | Director, Institute for Natural Resources – Portland, Portland State University

Posters

Stage 0 Restoration in the Willamette Headwaters: Staley Creek Case Study

Audrey Squires | Restoration Projects Manager, Middle Fork Willamette Watershed Council



Lisa Kurian | Hydrologist, U.S. Forest Service Middle Fork Ranger District

Matt Helstab | Fish Biologist, U.S. Forest Service Middle Fork Ranger District

From Seed to Sapling: A Life-Cycle Analysis of a Willamette Restoration Plant

Jean-Paul Zagarola | Senior Project Manager, Watershed Program, Bonneville Environmental Foundation



Tori Yoder | Program Technician, Watershed Program, Bonneville Environmental Foundation

Kathleen Guillozet | Director, Willamette Model Watershed Program, Bonneville Environmental Foundation

Community Advocacy for a Stronger Portland Harbor Superfund Solution

Cassie Cohen | Coordinator, Portland Harbor Community Coalition



Ibrahim Mubarak | Member, Portland Harbor Community Coalition and Executive Director, Right to Survive

Jessica Rojas | Member, Portland Harbor Community Coalition and Community & Environmental Engagement Manager, Northeast Coalition of Neighborhoods

Environmental Leadership for Youth: Empowering Underserved Youth as Conservation Leaders

Bessie Joyce | Coordinator, Environmental Leadership for Youth



Katherine Sincuir-Alvarez | Participant, Environmental Leadership for Youth



High Resolution Hydro-Acoustic River Mapping

Mark Lorang | Chief Science Officer, Freshwater Map



The Current Status of Willamette River Freshwater Mussels

Travis Williams | Executive Director, Willamette Riverkeeper



Investment in Oregon's Water Future

Stacey Dalgaard | Water Communications & Outreach
Director, Oregon Environmental Council



Soul River Inc.: Using the Healing Power of Rivers to Cultivate Youth and Veteran Leadership for Environmental Justice

Chad Brown | Founder & President, Soul River Inc.



Green Workforce Academy: Partnering to Diversify Today's Green Movement

Derron Coles, Ph.D. | Executive Director, The Blueprint Foundation



Rose High Bear (Deg Hit'an Dine, Inupiaq) | Senior Consultant, Wisdom of the Elders, Inc.

UPRIVER in the Classroom - Adapting a Film on Willamette River Restoration for Middle and High School Teachers



Jeremy Monroe | Director, Freshwaters Illustrated

Kathy Chambliss | Professional Development Coordinator, NorthBay Education Inc.



Keith Williams | Executive Director, NorthBay Education Inc.

Work underway in Support of Watersheds and People Experiencing Houselessness



Kathleen Guillozet | Director, Willamette Model Watershed Program, Bonneville Environmental Foundation



Michelle Emmons | South Valley Advocate, Willamette Riverkeeper

Preserving Farmland - Supporting Conservation, Business and Communities



Nellie McAdams | Farm Preservation Program Director, Rogue Farm Corps

Peter Kenagy | Board member, Oregon Farm Bureau



The Willamette-Laja Twinning Project

Tara Davis | Willamette-Laja Twinning Coordinator



Within Our Reach is presented by the Meyer Memorial Trust's Willamette River Initiative. Planning for the conference is led by Willamette River Initiative staff with help from a volunteer committee of Willamette River stakeholders. The Portland-based firm Social Enterprises provides event planning services.

Planning Committee

- Clinton Begley** | Long Tom Watershed Council
 - Kathleen Guillozet** | Bonneville Environmental Foundation
 - Jessica McDonald** | Greenbelt Land Trust
 - Heather Medina Saucedo** | USDA-NRCS
 - Liz Redon** | Oregon Watershed Enhancement Board
 - Courtney Shaff** | Oregon Watershed Enhancement Board
 - Rose Wallick** | U.S. Geological Survey
 - Priscilla Woolverton** | Oregon Dept. of Environmental Quality
- 